

DCHWS 2018 - Reception Exhibitor Instructions

Wednesday 4/18 and/or Thursday 4/19

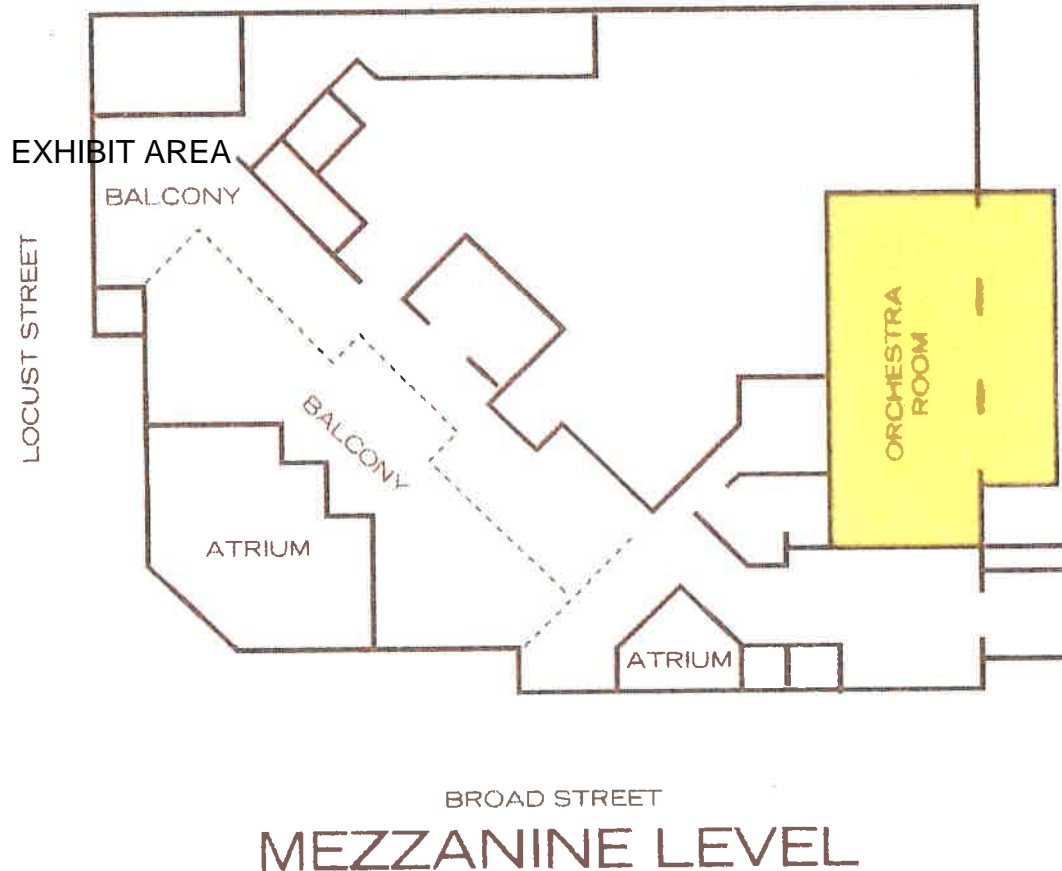

Exhibit space is located on the Mezzanine Level in the room titled Balcony in the area noted on the above schematic. Space will be pre-assigned for your table top display, please look for your company's name on the 6ft draped table that will be provided for you. Electricity will not be provided.

Exhibits can only be setup at the following times:

Wednesday 4/18 setup 2pm-4pm, breakdown after 7:30pm at the conclusion of reception

Thursday 4/19 setup 2pm-4pm, breakdown after 7:00pm at the conclusion of reception

Exhibits can be sent to the hotel no sooner than three days before the event.

Send to:

The DoubleTree c/o DCHWS 4/18

237 S. Broad St.

Philadelphia, PA 19107

(215) 893-1600

inquiries: karenb@ttienv.com